

**△ SPECIFICATION**

Impedance:50 Ohms  
 Frequency Range:DC 0~6GHz  
 V.S.W.R:1.3 Max.  
 RoHS Compliant

MCX - P C R XXX 50 - H  
 (1) (2) (3) (4) (5) (6) (7)

- (1) MCX:MCX Connector
- (2) P:Plug
- (3) C:Crimp Type
- (4) R:Right Angle
- (5) XXX:Cable Option  
 174:For Cable RG-174  
 188:For Cable RG-188  
 316:For Cable RG-316
- (6) 50:50 Ohms
- (7) H:RoHS Compliant

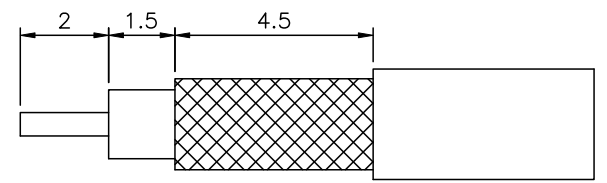
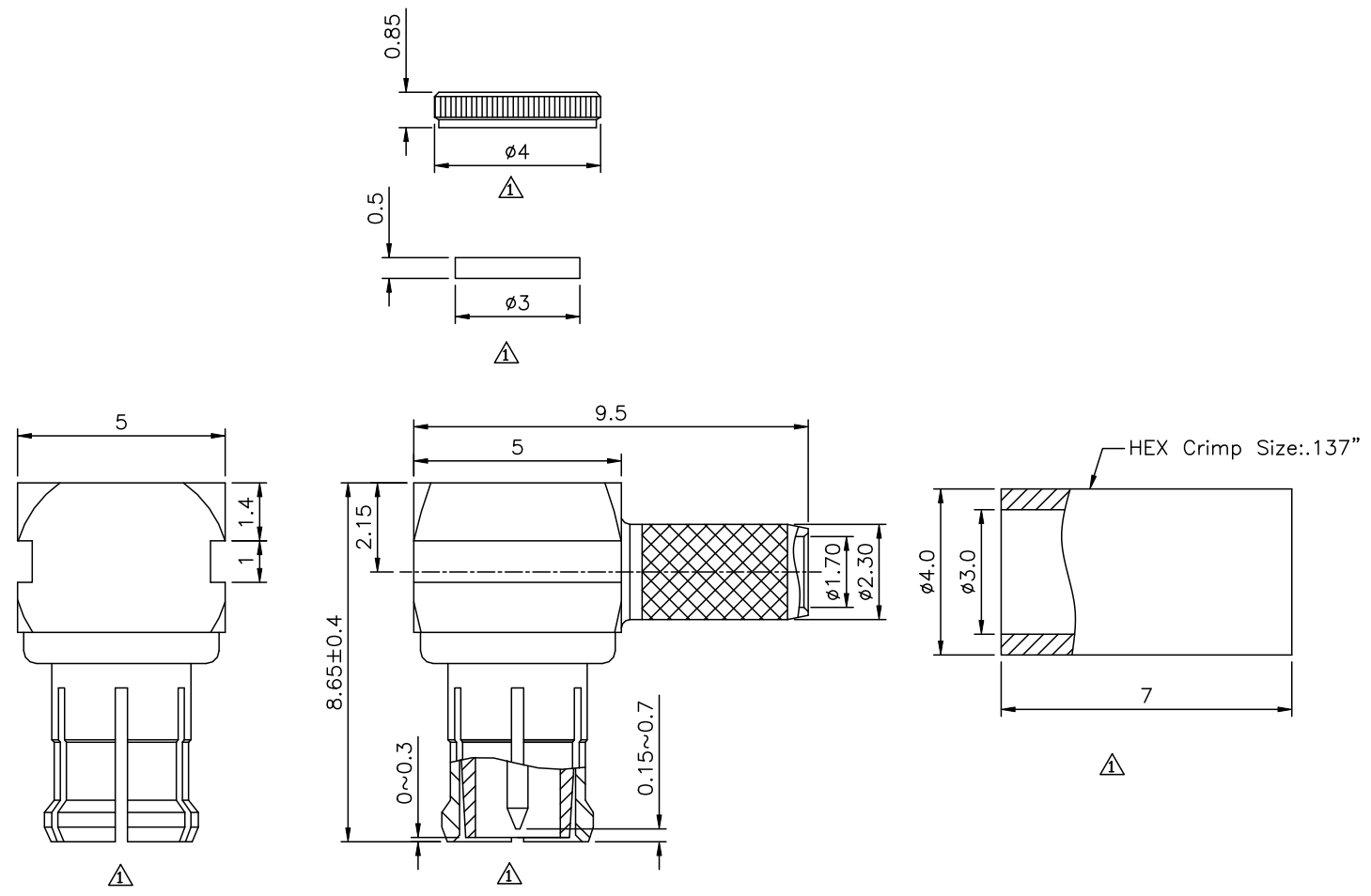

△ Recommended Strip Lengths

No.	Description	Material	Q'ty	Finish
⑦	Ferrule	Brass	1	Gold Plated Over Nickel
⑥	Insulator	Teflon	1	
⑤	Body	Beryllium Copper	1	Gold Plated Over Nickel
④	Center Pin	Brass	1	Gold Plated Over Nickel
③	Cube Body	Brass	1	Gold Plated Over Nickel
②	Insulator Cover	POM	1	
①	Press Cover	Brass	1	Gold Plated Over Nickel



CATEGORY	APPROVED BY	UNLESS OTHERWISE SPECIFIED TOLERANCES ARE		
PART No. MCX-PCRXXX50-H	MEI	X. ±0.10 .X ±0.10 .XX ±0.10		
DRAWING No. MCX-PCRXXX50-H	CHECKED BY HZF			
	DRAWING BY CYP			
SCALE NONE	REV. A1	UNIT mm	NO. REV.	DATE
			A1 Modify Data	HZF 06/06/2019
			A0 NEW RELEASE	HZF 08/10/2014
			REVISIONS	CHK DATE